

PROJECT NO:

\*\*\*\*\*

REV	DESCRIPTION	DATE	APPROVED
S0	CREATED DRAWING	2021/02/26	ZCH

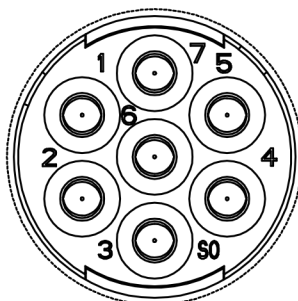

DETAIL A  
SCALE 3:1

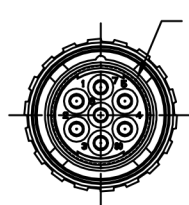

DETAIL A

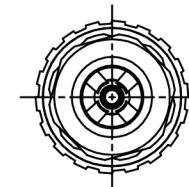
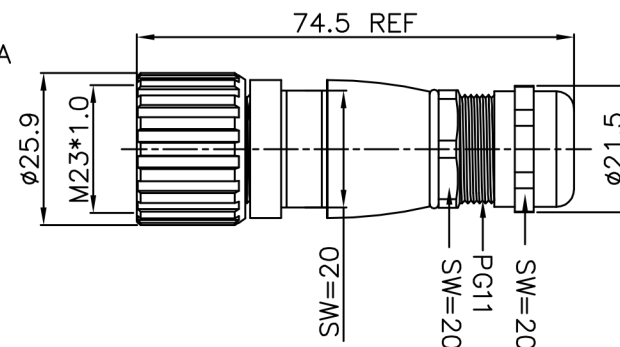

## Detailed Product Description:

Waterproof Connector Rating Is IP67

They Can Not Be Used Permanently Under Water.

Connector Electrical Character

Rating Voltage: 250V AC/DC ,

Rating Current : 20A

Insulation Resistance: &gt;100M ohms

Contact Resistance Of Connector ≤5m ohms

Mechanical Characteristics:

Mating / Cycle &gt;100 Cycles

Operating Temperature: -40°C ~ +115°C

Design From DIN EN60664 AND DIN EN61984

Applicable Wire: 2.5mm<sup>2</sup>(14AWG),

\*All Materials Are RoHS Compliant.

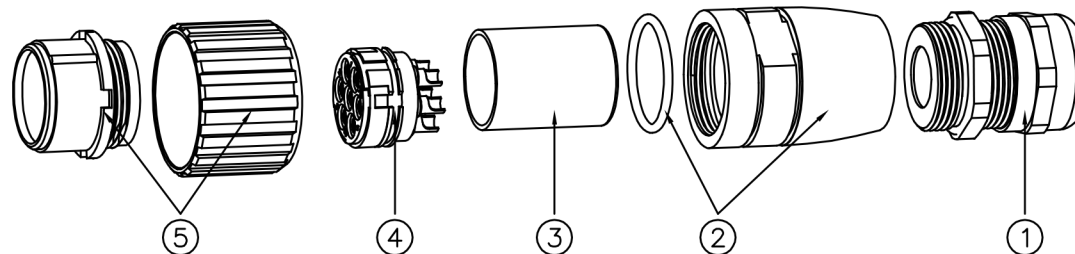
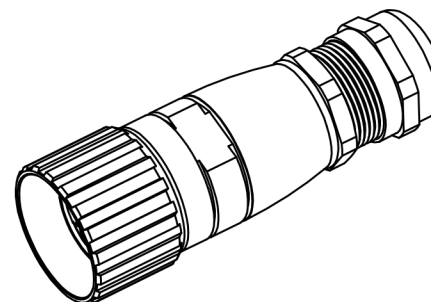

Shenzhen Signal Electronics co.,Ltd

DRAWING BY	DATE
CHECKED BY	DATE
CHECKED BY	DATE
APPROVED BY	DATE

THE INFORMATION CONTAINED IN THIS DRAWING IS THE SOLE  
PROPERTY OF SIGNAL COMPANY.  
ANY REPRODUCTION IN PART OR WHOLE WITHOUT THE WRITTEN  
PERMISSION OF SIGNAL COMPANY IS PROHIBITED.

TITLE M23 7 PIN FEMALE HEAD  
METAL ASSEMBLY (M23\*1.0)

SGN NO	230007-02-001	REV.
DWG NO		
CUSTOMER		

TOLERANCES ARE:	THIRD ANGLE PROJECTION	
DECIMALES	ANGLES	
.x ±0.5	x' ±2.0°	SIZE: A4
.xx ±0.20	.x' ±1.0°	UNITS: mm
		SCALE: 1:1
		SHEET: 1 OF 1