

REV	DESCRIPTION	DATE	APPROVED
S0	CREATED DRAWING	2022/11/05	ZK

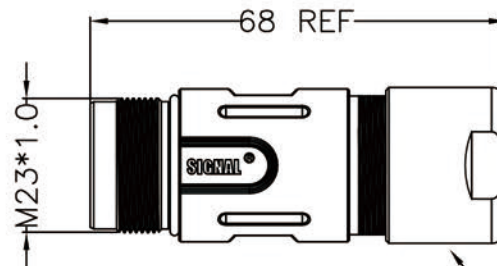
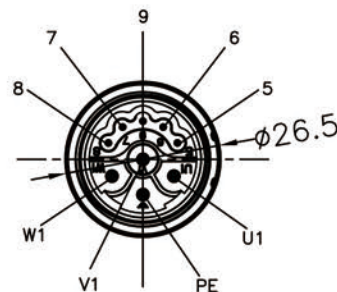

TERMINAL: CRIMP

CABLE OD: 7~12mm

Electrical character
Electrical character
Signal: Rating voltage: 250V AC/DC
Rating current: 10A
Power: Rating voltage: 600V AC/DC
Rating current: 28A
Insulation resistance: >100MΩ
Contact resistance: ≤5mΩ

Other Specification
Contact Pin: Brass with gold-plated
Insulation plastic: PA66
Shell: Zinc alloy
Protection degree: IP69K
Operating temperature: -40°C ~ +85°C

Power Core wire : 18~14AWG
Signal Core wire : 26~17AWG
Cable peeling : 30mm
Core wire peeling : 5~6mm

*ALL MATERIALS ARE RoHS COMPLIANT.

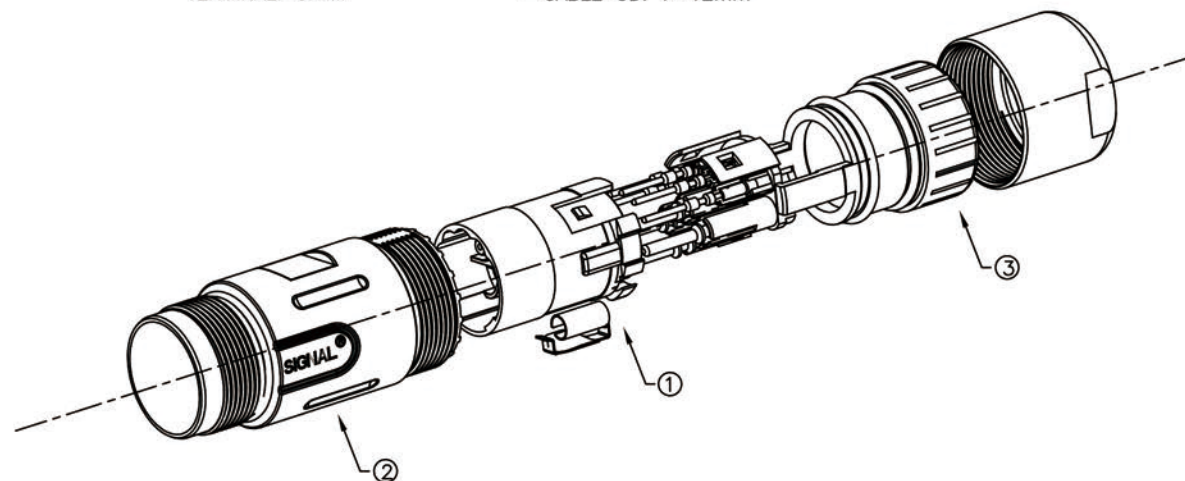

SIGNAL® Shenzhen Signal Electronics Co., LTD		TITLE M23 9PIN(5+3+PE) A MALE ASSEMBLY CONNECTOR	
		SGN NO 230009-01-008	REV. S0
DRAWN BY	DATE	DWG NO	
CHECKED BY	DATE	CUSTOMER	
CHECKED BY	DATE		
APPROVED BY	DATE		
<small>THE INFORMATION CONTAINED IN THIS DRAWING IS THE SOLE PROPERTY OF SIGNAL COMPANY. ANY REPRODUCTION IN PART OR WHOLE WITHOUT THE WRITTEN PERMISSION OF SIGNAL COMPANY IS PROHIBITED.</small>		TOLERANCES ARE:	
		DECIMALES	ANGLES
		.x ±0.5	x' ±2.0'
		.xx ±0.20	.x' ±1.0'
		THIRD ANGLE PROJECTION	
		SIZE: A4	UNITS: mm
		SCALE:	SHEET: 1 OF 1